



भा.कृ.अनु.प.- राष्ट्रीय लीची अनुसंधान केन्द्र

ICAR-NATIONAL RESEARCH CENTRE ON LITCHI
An ISO 9001:2008 Certified

(भारतीय कृषि अनुसंधान परिषद, कृषि मंत्रालय)

(Indian Council of Agricultural Research, Ministry of Agriculture)

मुशहरी प्रक्षेत्र, मुशहरी, मुजफ्फरपुर-842002 (बिहार) भारत

Mushahari Farm, Mushahari, Muzaffarpur - 842005 (Bihar) India

फोन Ph: 0621-2289475, 2281160

Email: nrclitchi@yahoo.co.in

फैक्स Fax: 0621-2281162



File No.14-1(22)/Estate/2019-20/Minor Works/Vol.-XI /2035-2045 .

Dated: 22.02.2020

Speed/Registered Post

To,

(As per enclosed List)

Sub: Quotation for "Making of Plant Protection ridge at back side of farm office-80.16 m³ and Water Pump Shade at Near Germ Plasm-II, Water Pump set-2 Shade at near H.D.P-20.55m²" at ICAR-National Research Centre on Litchi, Muzaffarpur (Bihar) -reg.

Sir,

ICAR-National Research Centre on Litchi, Muzaffarpur (Bihar) is a unit of Indian Council of Agriculture Research, Ministry of Agriculture, Govt. of India, invites quotations for "Making of Plant Protection ridge at back side of farm office-80.16 m³ and Water Pump Shade at Near Germ Plasm-II, Water Pump set-2 Shade at near H.D.P-20.55m²" at this Centre from the reputed and experienced contractor.

Sl. No.	Particulars	Qty.
1	Making of Plant Protection ridge at back side of farm office	80.16 m ³
2	Water Pump Shade at Near Germ Plasm-II and Water Pump set-2 Shade at near H.D.P" Attached specification	20.55m ²

Accordingly it is requested to quote your rates after visiting the site and keeping in view of the following terms and conditions:-

1. The offered rates quoted for F.O.R. ICAR-NRC on Litchi, Mushahari Farm, Muzaffarpur basis should reach this office on or before 17.03.2020 up to 4.00 PM at the latest by post. The quotation received thereafter will not be entertained.
2. It is mandatory to mentioned or attached copy of civil registration, GST and civil labour license alongwith proof of experience for doing this types of repairing works in other Govt./ICAR Institutes. Without civil registration GST & Labour license quotation will not consider.
3. The terms and conditions and specification may be seen on institute website: www:nrclitchi.org as well as CPP portal URL:http//eprocure.gov.in/eprocure/app.

4. **Security Deposit @ 10%** of quoted rate will be deducted from the bill which will be refundable after successfully completion of 01 year.
5. No advance payment will be made but payment is assured within 30 days from the date of completion of ordered work/supply with satisfaction and installation.
6. The quotation of quantity of work of the indentor might be increased or decreased at the discretion of the ICAR-Director, ICAR-National Research Centre on Litchi, Muzaffarpur, while placing the supply order.
7. The rates should be quoted for F.O.R. **ICAR-National Research Centre on Litchi, Mushahari Farm, Muzaffarpur basis.**
8. Tendering firms will be required to indicate their valid income Tax, works registration No. and Sales Tax number and submit their authorization of the manufacturer.
9. Conditional offers are liable to be rejected summarily.
10. **Note lowest offer should not be mandatory to accept on part of this institute.**
11. The Director, ICAR-National Research Centre for Litchi, Muzaffarpur (Bihar) reserves the right to accept or reject any of the quotations without assigning any reasons thereof.

The quotations should be addressed to the **Director, ICAR-National Research Centre for Litchi, (Indian Council of Agricultural Research) Mushahari Farm, Mushahari, Muzaffarpur – 842002 (Bihar)** in a sealed cover **“Making of Plant Protection ridge at back side of farm office- 80.16 m³ and Water Pump Shade at Near Germ Plasm-II, Water Pump set-2 Shade at near H.D.P-20.55m²”.**

Yours faithfully,

Administrative Officer (I/c)
ICAR-NRC on Litchi, Muzaffarpur
nrlitchi@yahoo.co.in

Specification of Water Pump Shade

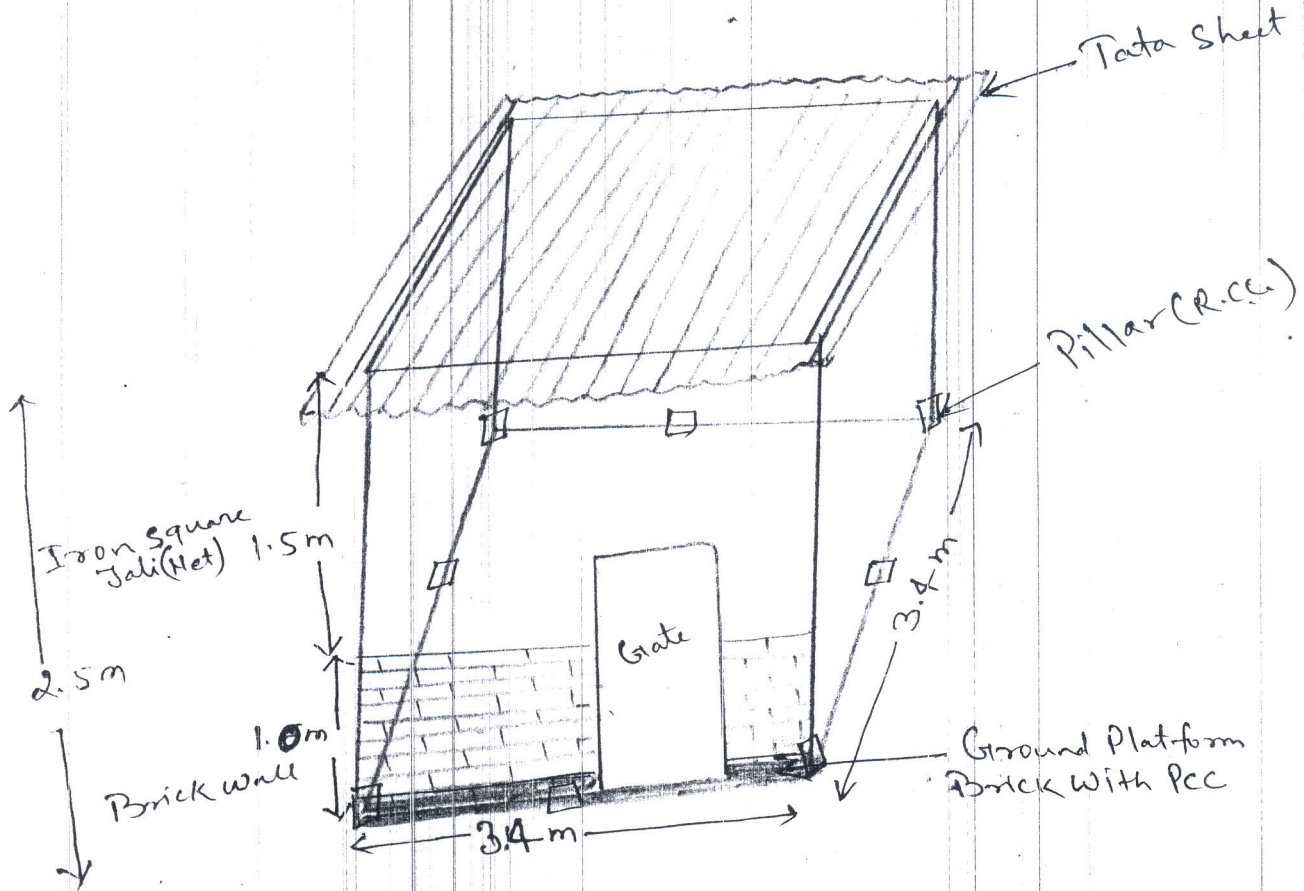

Requirement: (1) Square Pipe 2" & 1 1/2" as per need
(Approx.)

(2) Wall length = 12.7 m

(3) Height = 1 m (from ground platform)

(4) Square iron Jali Area = $13.7 \text{ m} \times 1.5 \text{ m} = 20.55 \text{ m}^2$

(5) Tata sheet

(6) Gate

(7) ~~Brick~~ ground brick with PCC

(8) No. of Pillar (RCC) = 8

[Signature]
12/02/2020

Layout: ~~Design~~^{MAKING} of Plant Protection ridge and Lawn

(1)

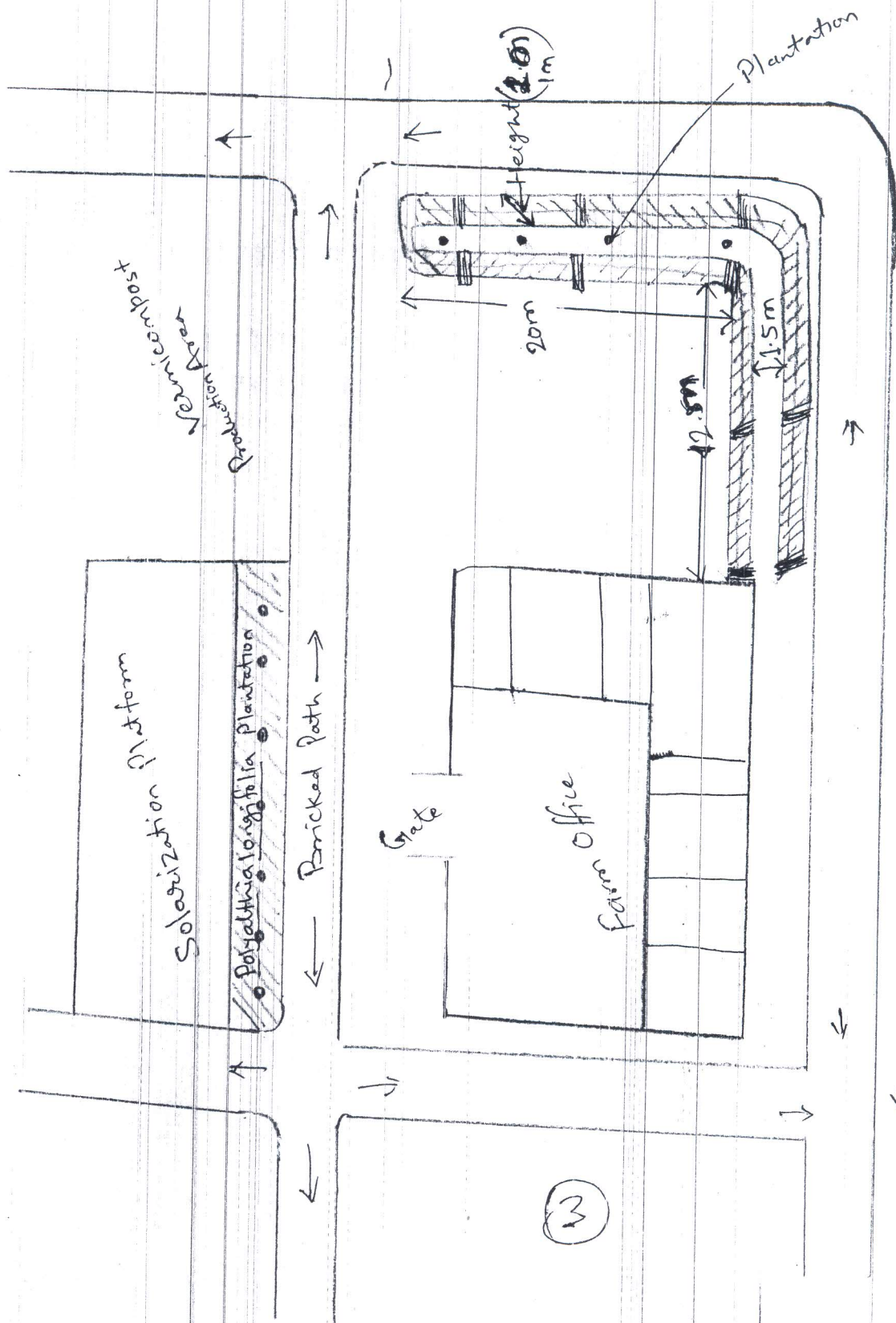

(2)

(5)

Summa
12/02/2020

Length of wall = 32 m
Height = 1 m

No. of Pillar = 10 NOS.

Soil filling volume of ridged bed = $0.67\text{ m} \times 32\text{ m} \times 1.5\text{ m} = 32.16\text{ m}^3$
 Soil filling vol. of Ground = $0.2\text{ m} \times 12\text{ m} \times 20\text{ m} = 48\text{ m}^3$
 Flat soding area = $1.5\text{ m} \times 32\text{ m} = 48\text{ m}^2$
 Tiles fitting area = $1.5\text{ m} \times 32\text{ m} = 48\text{ m}^2$

} = 80.16 m³ (Tot)